

HUDSON RAILYARDS REDEVELOPMENT: digital infrastructure

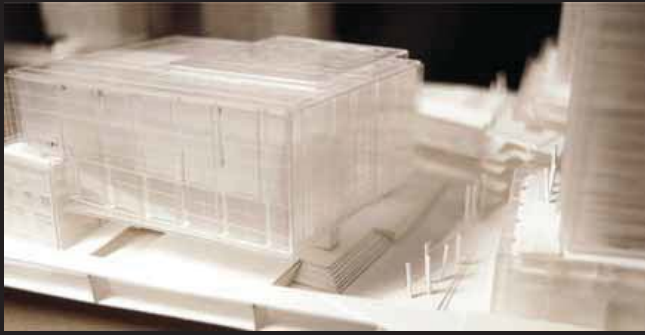

The project began with research into the Highline, a 1.45 mile long eco-corridor built on top of derelict train tracks that have been transformed into a linear park that traverses the city and terminates on the site. The design problem called for the establishment of a cultural center on the site with a specific identity. The cultural amenity selected for our design was one of digital arts and media.

This art form combines the poetics of the art world and the technology of the digital world and as such has become increasingly responsive to human input and interaction. The development of technology allows software to take entries from viewers and incorporate them into the actual display.

In the spirit of the Eyebeam Atelier, a digital arts museum, the site seeks to “actively engage with culture, addressing the issues and concerns of our time.” This central tenet lends itself to the practice of reevaluating the basic relationships between society and culture and to discern how they can be best served by digital arts.

In the spirit of the Eyebeam Atelier, a digital arts museum, the site seeks to “actively engage with culture, addressing the issues and concerns of our time.” This central tenet lends itself to the practice of reevaluating the basic relationships between society and culture and to discern how they can be best served by digital arts.

